



*Satellite Suites*

**TRAILER DIVISION**

RESTROOM, ADA, SHOWER, HANDWASH & SPECIALTY

MILLENNIUM ULTRA | 25' 10-STATION



SPA GRAY | 14' 4-DOOR, 4-STATION



6X14' 2-DOOR, 4-STATION



6X14' 3-DOOR, 3-STATION



6X14' 4-DOOR, 4-STATION

## MOST VERSATILE TRAILER

Satellite Suites 14' restroom trailers are among the most popular trailers on the market and for good reason. These revenue boosters come in three different floor plans, allowing you the versatility needed to accommodate events both large and small.

Available in Satellite's Commercial, Spa and Millennium interiors, these spacious restrooms can be used for a variety of situations, from oil fields to wedding venues. The individual floor designs and stunning interiors will give your customers that "At Home Experience," leaving them in comfort and awe!

If you haven't yet added a trailer to your fleet and want to increase your bottom line. Satellite's 14' trailers would be a great addition!

Give your customers the Finest Experience portable sanitation has to Offer!



COMMERCIAL GRAY | 14' 2-DOOR, 4-STATION

# TABLE OF CONTENTS

- 1 SELFIE:** SELFIE, SELFIE SLIM, SELFIE POD
- 3 SPA GRAY:** 14' | 4-DOOR, 4-STATION
- 5 SPA TAN:** 20' | 8-STATION
- 7 COMMERCIAL GRAY:** 28' | 11-STATION
- 9 MILLENNIUM:** 25' | 10-STATION
- 11 FLEX:** 29' | 9-STATION, 29' | 10-STATION
- 13 10' | 2-STATION**
- 15 17' | 6-STATION**
- 17 ADA:** 11' | 1-STATION, 19' | 3-STATION, 23' | 3-STATION SHOWER
- 19 SHOWER:** FLEX 8-STATION, 8-DOOR 8-STATION, 3-STATION COMBO
- 21 HANDWASH:** SINK SUITE, SINK SUITE PLUS, SINK SUITE DELUXE
- 23 SPECIALTY:** LAUNDRY 8-STATION
- 25 FLOOR PLANS:** SELFIE, RESTROOM
- 27 FLOOR PLANS:** ADA, SHOWER, HANDWASH, SPECIALTY



SELFIE GRAY INTERIOR

## SELFIE | 2 STATION

The Selfie is a sleek, go-anywhere, do-anything, two-station restroom trailer that comes with all the amenities of your very own bathroom and the spacious, roomy interior is a pleasant surprise! Standard trailers come complete with flushing toilets, stainless-steel sinks, wide counter tops, mirrors, and bright ambient lighting. For those wanting to upgrade, add AC, additional heat, a sound system, water heater or aluminum wheels.

Satellite Suites built the Selfie to accommodate small parties and events up to 150 people. Using one simple electrical plug or the solar upgrade, the Selfie can operate all day with a full fresh water tank. For larger and longer events, hook the Selfie up to a fresh water source, electric outlet and sewer drain, and party on!

*\*All Selfie models are available Internationally and in white or gray interior.*



SELFIE WHITE INTERIOR

- NO. OF STATIONS** - 2
- FRESHWATER** - 103 GAL
- WASTEWATER** - 132 GAL
- WEIGHT** - 3,300 LBS
- WHEELS** - 14" ALUMINUM
- AXLE** - 3,500 LB TORSION



## SELFIE SLIM | 2 STATION

At Satellite Suites, we want to make adding a trailer to your operation simple, affordable and profitable. Selfie SLIM does this and more. When your customers experience the privacy and comfort of a Selfie SLIM trailer, it will be the restroom they ask for when planning their next event.



- NO. OF STATIONS** - 2
- FRESHWATER** - 104 GAL
- WASTEWATER** - 205 GAL
- WEIGHT** - 3,800 LBS
- WHEELS** - 14" ALUMINUM
- AXLE** - (2) 3,500 LB TORSION

## SELFIE POD | 2 STATION

The Selfie POD is becoming a popular option when customers want a higher-end portable restroom indoors or for long-term rental. Examples are remodeling of bathrooms in large retail stores, refineries, vineyards and similar applications.



- NO. OF STATIONS** - 2
- FRESHWATER** - 94 GAL
- WASTEWATER** - 132 GAL
- WEIGHT** - 2,820 LBS



20' | 8 STATION

### SPA GRAY

Satellite Suites Spa Gray interior will leave the end-user wondering if they are at home or in a restroom trailer. The cool, soft colors create a pleasing atmosphere making every end-users experience a great one.

*\*Spa Gray Interior is available in all trailer sizes.*



14' | 4 STATION

### 14' | 4 DOOR, 4 STATION

Satellite Suites 14' 4-Door, 4-Station trailer, has more space than you would expect in a trailer this size.

Beyond the roomy layout is the ease of towing and set-up. The steps, leveling jacks and door handles can be deployed in just a matter of minutes, while the water and electrical connections are positioned for quick access.

*\*All 14'-Trailers are Available Internationally and in all Interiors.*

- NO. OF STATIONS** - 4
- FRESHWATER** - 200 GAL
- WASTEWATER** - 390 GAL
- WEIGHT** - 5,280 LBS
- WHEELS** - 16" ALUMINUM
- AXLE** - 7,000 LB TORSION

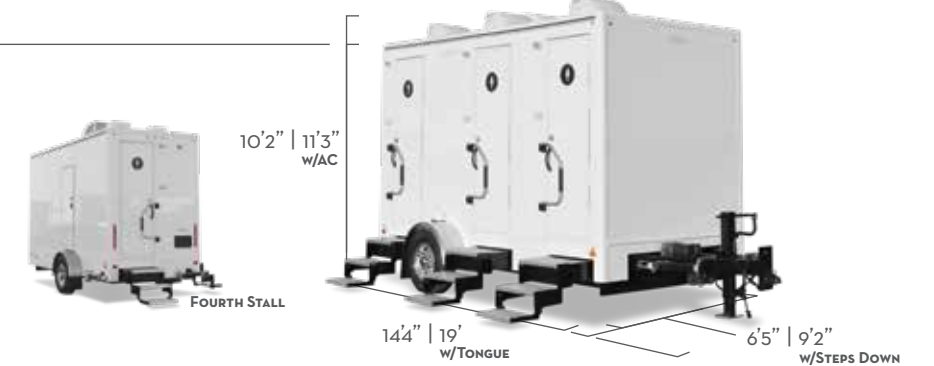

## 20' | 8 STATION

Lightweight, spacious and beautiful describe this 20', 8-Station portable restroom trailer designed for both operators and end-users. Weighing less than 8,500 pounds, this restroom trailer is a pleasure to transport and simple to place and set-up.

Inside, the ladies area has four spacious stalls and a twin-basin vanity. For the men, there are two private stalls, two urinals and a twin-basin vanity. The climate in each area can be controlled by individual air conditioning units to insure total comfort.

*\*Available Internationally and in all Interiors.*



20' | 8 STATION

## SPA TAN

The Tan interior for the SPA series was created at the request of Satellite Suites customers who thought the color would be a nice option. After manufacturing the first one, we fully agreed, and now it has become a very popular choice for operators.

*\*Spa Tan Interior is available in all trailer sizes.*



20' | 8 STATION



- NO. OF STATIONS** - 8
- FRESHWATER** - 200 GAL
- WASTEWATER** - 750 GAL
- WEIGHT** - 8,490 LBS
- WHEELS** - 16" ALUMINUM
- AXLE** - (2) 7,000 LB TORSION



28' | 11 STATION

## COMMERCIAL

Durability is the key feature of our Commercial Duty restroom trailer, but you will also notice the interior design is nice enough for a special event. We built it to accommodate operators who have mixed uses, from oil fields to bridal events, using heavy-duty, waterproof materials in a color palette acceptable for bikers or brides.

*\*Commercial Interior is available in all trailer sizes.*



28' | 11 STATION

## 28' | 11 STATION

Satellite Suites has created a beautiful 28-foot, eleven-station trailer for high traffic events. This trailer has five private stalls and two sinks for the women and four urinals, two stalls and two sinks for the men.

Both the men's and women's areas are equipped with an entrance and exit door to create a safe, even flow of traffic. The common areas are very large and spacious, giving users a comfortable environment to share.



- NO. OF STATIONS** - 11
- FRESHWATER** - 200 GAL
- WASTEWATER** - 1,000 GAL
- WEIGHT** - 11,450 LBS
- WHEELS** - 16" ALUMINUM
- AXLE** - (2) 7,000 LB TORSION

## MILLENNIUM

The array of soft, cool colors and beautiful styling used in our Millennium restroom trailer will elevate the mood of any occasion. With its beautiful smooth light gray walls, built in vessel sinks and shaker style stall doors, you might think we traded styling for durability. Not so. All the materials are completely waterproof (wood trim, cabinet faces, and wood doors are not waterproof). Every item, from the solid vanity top and transit grade textured floor to the seamless white fiberglass ceiling, will maintain its beauty and charm year after year.

*\*Millennium Interior is available in all trailer sizes and can also be upgraded to the Millennium Ultra (shown on cover and back).*



## 25' | 10 STATION

Lightweight, spacious and beautiful best describe this 25', 10-Station trailer. Inside, the ladies area has five spacious stalls and a twin-basin vanity. For the men, there are two private stalls, three urinals and a two single basin vanities. The climate in each area can be controlled by individual air conditioning units to ensure total comfort.

*\*Available Internationally and in all Interiors.*



- NO. OF STATIONS** - 10
- FRESHWATER** - 200 GAL
- WASTEWATER** - 880 GAL
- WEIGHT** - 9,800 LBS
- WHEELS** - 16" ALUMINUM
- AXLE** - (2) 7,000 LB TORSION



29' FLEX | 9 STATION | GRAY SPA

### 29' FLEX | 10 STATION

The Flex 10-Station portable restroom trailer comes with one extra urinal to help with those high traffic events that just need a little more. The beautiful, stylish interiors that Satellite offers in it gives you and your customer's the flexibility needed when hosting an event. It can be configured for male/female use in a 5+5 or 3+7 floor plan, or as a 10 station depending on gender requirements.

*\*Available in all Interiors.*



29' FLEX | 10 STATION | GRAY COMMERCIAL

### 29' FLEX | 9 STATION

Beautiful, Spacious and Flexible describe this 29' Flex 9-Station restroom trailer. Equipped with dual sinks at both ends, this trailer will offer you and your customer's superior flexibility when it comes to planning events. It can be configured for male/female use in a 5+4 or 3+6 floor plan, or as a 9 station depending on gender requirements.

*\*Available in all Interiors.*



#### 9 STATION FLEX

- NO. OF STATIONS** - 9
- FRESHWATER** - 300 GAL
- WASTEWATER** - 1,025 GAL
- WEIGHT** - 11,980 LBS
- WHEELS** - 16" ALUMINUM
- AXLE** - (2) 7,000 LB TORSION

#### 10 STATION FLEX

- NO. OF STATIONS** - 10
- FRESHWATER** - 300 GAL
- WASTEWATER** - 1,025 GAL
- WEIGHT** - 11,980 LBS
- WHEELS** - 16" ALUMINUM
- AXLE** - (2) 7,000 LB TORSION





### 10' | 2 STATION

As guests enter this private, 2-Station restroom trailer they are struck by the warm, comfortable surroundings. The soft music and clean, well-lit interior provides a pleasant atmosphere where they can escape from the crowd and enjoy a few moments alone.

*\*Available Internationally and in all Interiors.*



10' | 2 STATION | SPA GRAY



10' | 2 STATION | COMMERCIAL GRAY





### 17' | 6 STATION

Satellite Suites would like to introduce the perfect mid-size restroom trailer, the new 17' 6-station. This trailer is ideal for events between 400-450 guests. The spacious and open floor plan allows for traffic to move quickly in and out, reducing long wait lines. It's unique size makes it easy to pull and easy to maneuver into place.

*\*Available Internationally and in all Interiors.*



17' | 6 STATION | SPA GRAY



- NO. OF STATIONS** - 6
- FRESHWATER** - 200 GAL
- WASTEWATER** - 525 GAL
- WEIGHT** - 7,121 LBS
- WHEELS** - 16" ALUMINUM
- AXLE** - (2) 7,000 LB TORSION



10' ADA | 1 STATION | COMMERCIAL INTERIOR

### ADA

Our ADA trailers are operator and user friendly for a wide variety of reasons. With only a six inch rise, users can easily travel up and down the ramp with minimal effort. The ramp itself is made up of two sections of lightweight aluminum for quick set-up and tear down. The ramps can also be configured from the main platform to face left, right or straight ahead, whichever works best.

*\*ADA restrooms are available in all interiors and all sizes are available Internationally.*



19' ADA | 3 STATION | SPA GRAY INTERIOR

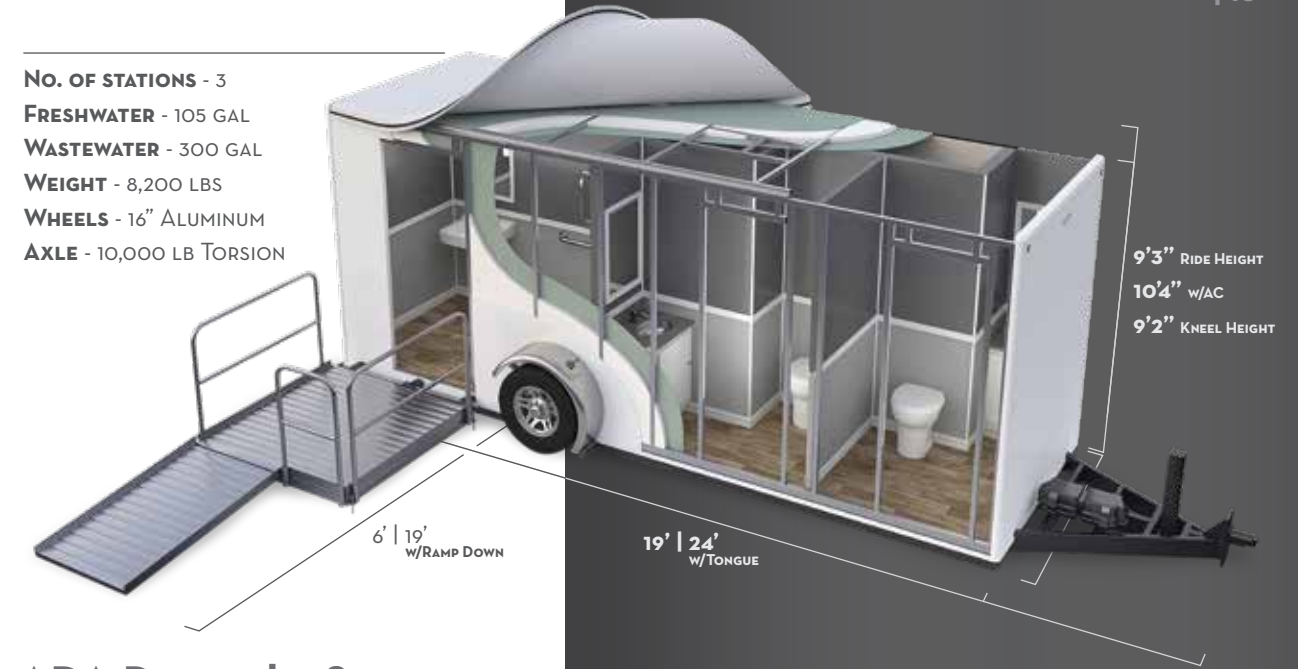

**NO. OF STATIONS - 3**  
**FRESHWATER - 105 GAL**  
**WASTEWATER - 300 GAL**  
**WEIGHT - 8,200 LBS**  
**WHEELS - 16" ALUMINUM**  
**AXLE - 10,000 LB TORSION**

9'3" RIDE HEIGHT  
 10'4" W/AC  
 9'2" KNEEL HEIGHT

6' | 19" W/RAMP DOWN

19' | 24" W/TONGUE

### ADA PLUS 2 | 3 STATION

Satellite's ADA+2 is great for events. One person can easily set-up or take down the trailer in 10 minutes! That means you can manage your events with fewer people and still offer exceptional service. The feature event organizers like best is having two full-sized unisex bathrooms in addition to the comfortable ADA bathroom!



SHOWER VIEW

TOILET VIEW

### ADA | SINGLE STATION

Our single station ADA is priced right while utilizing the latest technology, including our unique vacuum flush system, remote controlled electronic jacks and lightweight, modular ramp. And the best news is that it can be set-up and torn-down by one person, saving labor costs.



6' | 10'4" W/RAMP DOWN

11' | 16" W/TONGUE

9'3" RIDE HEIGHT  
 10'4" W/AC  
 9'2" KNEEL HEIGHT

**NO. OF STATIONS - 1**  
**FRESHWATER - 63 GAL**  
**WASTEWATER - 123 GAL**  
**WEIGHT - 3,200 LBS**  
**WHEELS - 15" ALUMINUM**  
**AXLE - 5,200 LB TORSION**

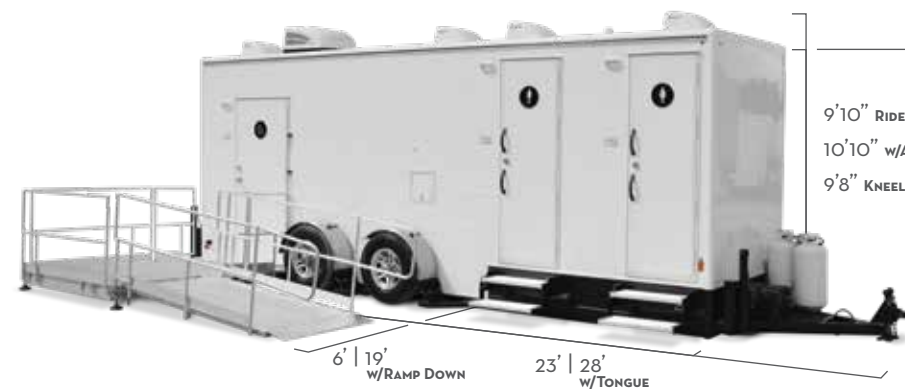

6' | 19" W/RAMP DOWN

23' | 28" W/TONGUE

9'10" RIDE HEIGHT  
 10'10" W/AC  
 9'8" KNEEL HEIGHT

**NO. OF STATIONS - 3**  
**FRESHWATER - 105 GAL**  
**WASTEWATER - 300 GAL**  
**WEIGHT - 8,200 LBS**  
**WHEELS - 16" ALUMINUM**  
**AXLE - (2) 10,000 LB TORSION**

### ADA SHOWER | 3 STATION

Satellite's ADA shower is the best combo for those extended stay locations. Equipped with a full ADA complaint shower/restroom and two individual restrooms.



28' FLEX SHOWER | 8 STATION

### SHOWER/RESTROOM | 3 STATION

This trailer has three spacious, private shower rooms complete with sink and a toilet. Your customers will feel at ease showering and changing in a space all their own, with the added convenience of their own restroom facilities.

*\*Available Internationally.*



18' COMBO SHOWER | 3 STATION

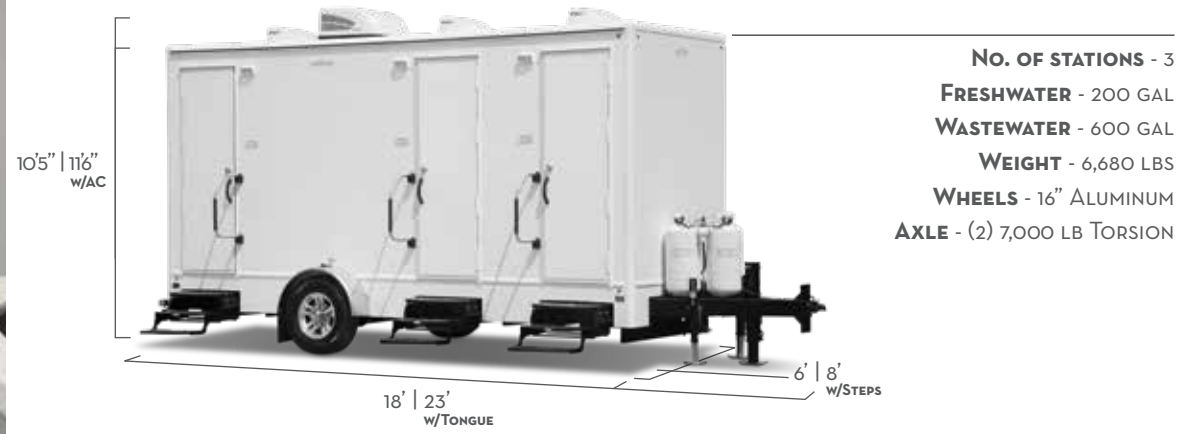

**NO. OF STATIONS - 3**  
**FRESHWATER - 200 GAL**  
**WASTEWATER - 600 GAL**  
**WEIGHT - 6,680 LBS**  
**WHEELS - 16" ALUMINUM**  
**AXLE - (2) 7,000 LB TORSION**

10'5" | 11'6"  
w/AC

18' | 23'  
w/TONGUE

6' | 8"  
w/STEPS

### FLEX SHOWER | 8 STATION

The Satellite Suites 28' 8-Station Flex shower trailer offers you and your customers unparalleled flexibility. It can be configured as a 2 x 6, 4 x 4 or full 8 shower trailer, with each section having at least one sink and mirror. In addition, each individual shower has its own changing area with a private lock.

SATELLITEINDUSTRIES.COM

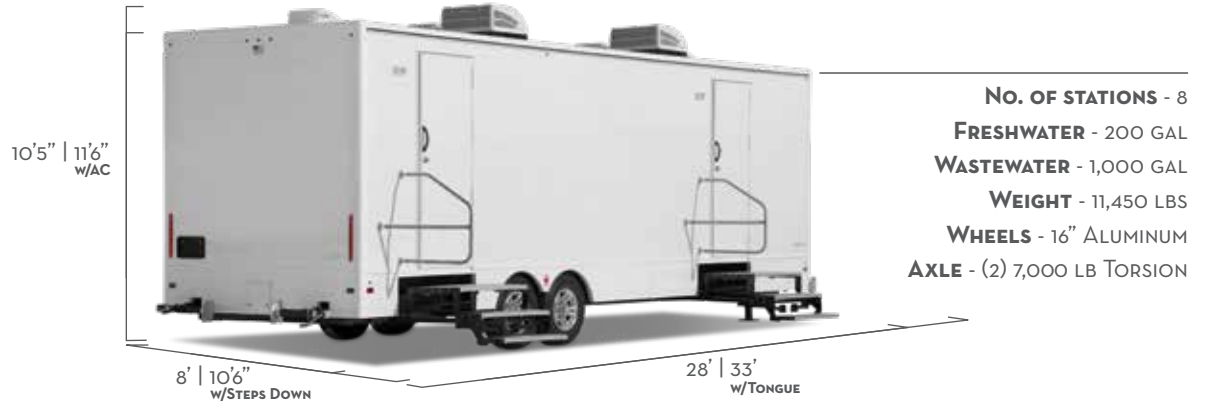

**NO. OF STATIONS - 8**  
**FRESHWATER - 200 GAL**  
**WASTEWATER - 1,000 GAL**  
**WEIGHT - 11,450 LBS**  
**WHEELS - 16" ALUMINUM**  
**AXLE - (2) 7,000 LB TORSION**

10'5" | 11'6"  
w/AC

8' | 10'6"  
w/STEPS DOWN

28' | 33'  
w/TONGUE

### 8 DOOR SHOWER

This Beautiful 8-Door, 8-Station shower trailer is the most private shower trailer on the market. Each shower has its own access and temperature control giving each user complete privacy and comfort.

*\*Same trailer is offered in an 8-Station Restroom.*



**NO. OF STATIONS - 8**  
**WIDTH/STEPS DOWN - 8'5" | 10'5"**  
**FRESHWATER - 200 GAL**  
**WASTEWATER - 1000 GAL**  
**WEIGHT - 13,000 LBS**  
**WHEELS - 16" ALUMINUM**  
**AXLE - (2) 7,000 LB TORSION**

10'5" | 11'6"  
w/AC

28' | 32'  
w/TONGUE



28' 8 DOOR SHOWER | 8 STATION

1.800.883.1123



## SINK SUITE | 12 STATION

Looking for an innovative solution to the growing demand for handwash units? Look no further! The Satellite Suites Sink Suite will serve groups of all sizes with an open, functional design and large water capacity to meet your customers' needs without infringing on your drivers daily routine. The 16' reinforced chassis allows it to be trailered with a full fresh OR graywater tank, making it easy to set-up and take-down. Bulk soap and paper towel dispensers along with push button metered faucets assure full days of service.

*\*All Sink Suites are available internationally.*

## SINK SUITE PLUS | 12 STATION

The Sink Suite Plus is fitted with plastic soap and paper towel dispensers for quick service and ease of maintenance. The flip up sides keep your sink trailer clean, while protecting faucets and dispensers from damage during transit.



### SINK SUITE PLUS

- NO. OF STATIONS** - 12
- NO. OF USES** - 4000
- FRESHWATER** - 525 GAL
- WASTEWATER** - 525 GAL
- DRY WEIGHT** - 4,000 LBS
- WHEELS** - 16" ALUMINUM
- AXLE** - (2) 5,200 LB TORSION
- TANKLESS WATER HEATER** - (2) 60,000 BTU

## SINK SUITE DELUXE | 12 STATION

Step it up a notch with the Sink Suite Deluxe. This trailer is fitted with beautiful stainless steel faucets and dispensers. Dual access to the service area allows for quick and easy maintenance.



### SINK SUITE

- NO. OF STATIONS** - 12
- NO. OF USES** - 4000
- FRESHWATER** - 525 GAL
- WASTEWATER** - 525 GAL
- DRY WEIGHT** - 4,000 LBS
- WHEELS** - 16" ALUMINUM
- AXLE** - (2) 5,200 LB TORSION
- TANKLESS WATER HEATER** - (2) 60,000 BTU



SINK SUITE & SINK SUITE PLUS



### SINK SUITE DELUXE

- NO. OF STATIONS** - 12
- NO. OF USES** - 4000
- FRESHWATER** - 525 GAL
- WASTEWATER** - 525 GAL
- DRY WEIGHT** - 4,000 LBS
- WHEELS** - 16" ALUMINUM
- AXLE** - (2) 5,200 LB TORSION
- TANKLESS WATER HEATER** - (2) 60,000 BTU





BACK TO FRONT VIEW

## LAUNDRY TRAILER | 8 STATION

Satellite Suites would like to introduce the 24' 8-Station Laundry Trailer. Built to accommodate large groups of service workers and people in disaster relief situations. Eight Samsung Stackable washer/dryer units, two folding stations and one laundry sink outfit the trailer. The open floor plan allows for people to flow easily in and out of the trailer, maximizing the amount of productivity.

*\*Requires fresh water and wastewater connection.  
No on board tanks.*



FRONT TO BACK VIEW



SINK & FOLDING STATION



FRONT



- NO. OF STATIONS - 8**
- FRESHWATER - CONNECTION**
- WASTEWATER - CONNECTION**
- WHEELS - 16" ALUMINUM**
- AXLE - (2) 7,000 LB TORSION**

**SELFIE MODELS**

NO. OF STATIONS  
LENGTH/W TONGUE  
WIDTH/W STEPS  
HEIGHT/W AC  
FRESH TANK  
WASTE TANK  
WEIGHT  
AXLE TORSION

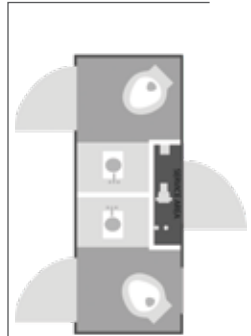

**SELFIE POD**  
2  
9'1"  
3'6" | 4'7"  
8'2" | 9'3"  
94 GAL.  
132 GAL.  
2,820 LBS.  
NA

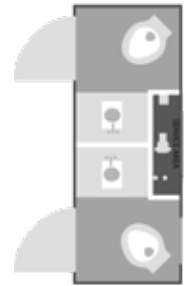

**SELFIE SLIM**  
2  
9'1" | 13'6"  
5'2" | 6'6"  
8'10" | 9'11"  
103 GAL.  
132 GAL.  
3,300 LBS.  
3,500 LB.

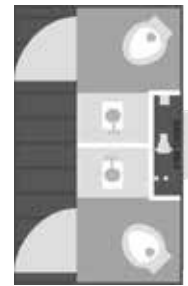

**SELFIE**  
2  
10'6" | 15'2"  
7'7" | 8'8"  
9'2" | 10'2"  
104 GAL.  
205 GAL.  
3,800 LBS.  
(2) 3,500 LB.

**RESTROOM MODELS**

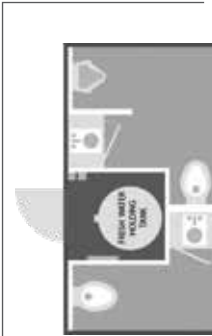

**10 FOOT**  
2  
10' | 15'  
6' | 7'6"  
10'11"  
105 GAL.  
265 GAL.  
4,200 LBS.  
7,000 LB.

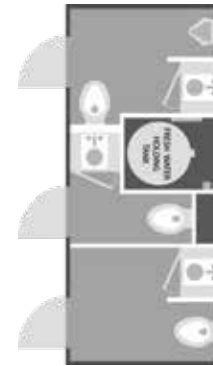

**14 FOOT | 3 DOOR**  
3  
14'4" | 19'  
6'5" | 9'2"  
11'3"  
200 GAL.  
390 GAL.  
5,280 LBS.  
7,000 LB.

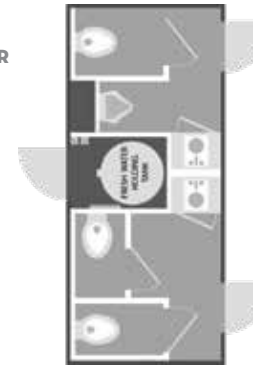

**14 FOOT | 2 DOOR**  
4  
14'4" | 19'  
6'5" | 9'2"  
11'3"  
200 GAL.  
390 GAL.  
5,280 LBS.  
7,000 LB.

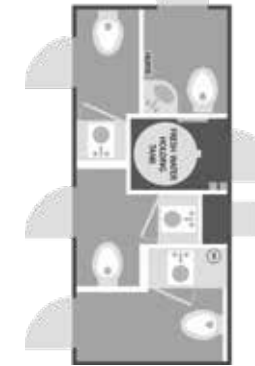

**14 FOOT | 4 DOOR**  
4  
14'4" | 19'  
6'5" | 9'2"  
11'3"  
200 GAL.  
390 GAL.  
5,280 LBS.  
7,000 LB.



**17 FOOT**  
6  
17' | 22'  
8'6" | 9'6"  
11'8"  
200 GAL.  
525 GAL.  
7,121 LBS.  
(2) 7,000 LB.

**RESTROOM MODELS**

NO. OF STATIONS  
LENGTH/W TONGUE  
WIDTH/W STEPS  
HEIGHT/W AC  
FRESH TANK  
WASTE TANK  
WEIGHT  
AXLE TORSION

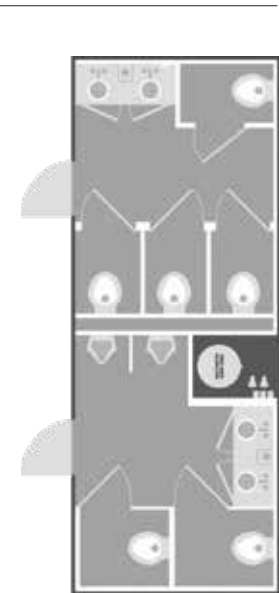

**20 FOOT**  
8  
20' | 25'  
8'6" | 12'6"  
11'8"  
200 GAL.  
750 GAL.  
8,490 LBS.  
(2) 7,000 LB.

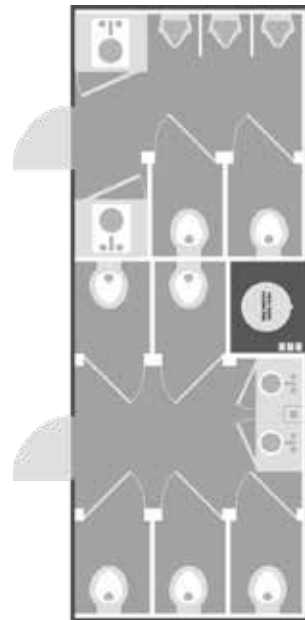

**25 FOOT**  
10  
25' | 30'  
8'6" | 12'6"  
11'8"  
200 GAL.  
880 GAL.  
9,800 LBS.  
(2) 7,000 LB.

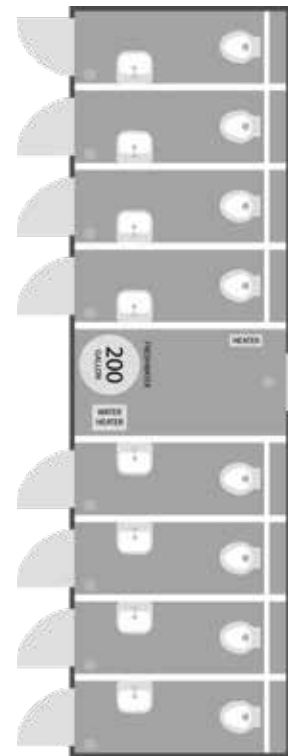

**28 FOOT | 8 DOOR**  
8  
28' | 33'  
8'6" | 12'6"  
11'8"  
200 GAL.  
1,150 GAL.  
11,450 LBS.  
(2) 7,000 LB.

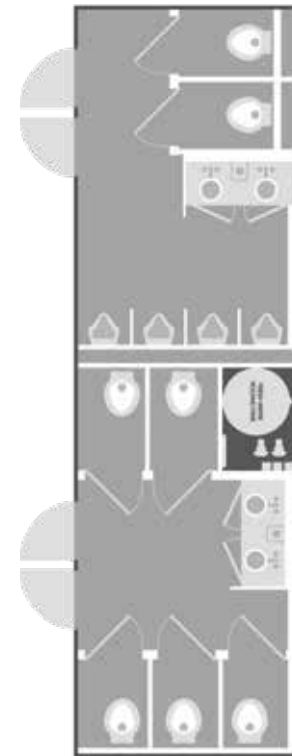

**28 FOOT**  
11  
28' | 33'  
8'6" | 12'6"  
11'8"  
200 GAL.  
1,000 GAL.  
11,450 LBS.  
(2) 7,000 LB.

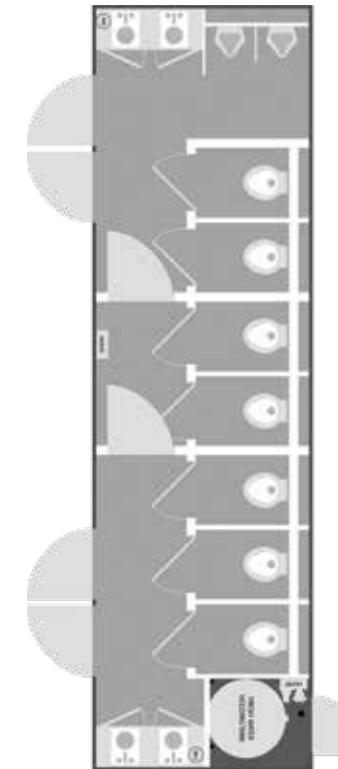

**29 FOOT | 9 STATION**  
9  
29' | 34"  
8'6" | 12'6"  
11'8"  
300 GAL.  
1,025 GAL.  
11,980 LBS.  
(2) 7,000 LB.

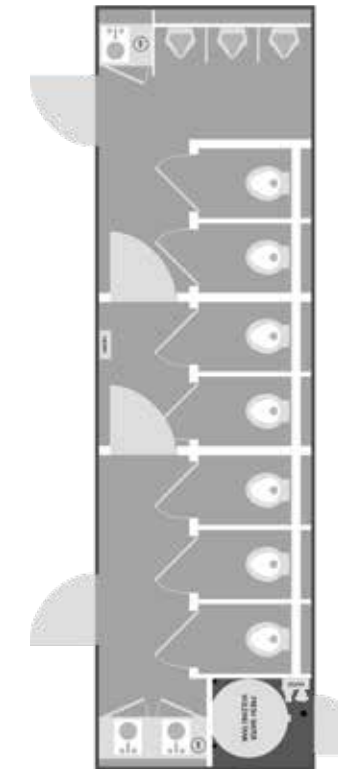

**29 FOOT | 10 STATION**  
10  
29' | 34"  
8'6" | 12'6"  
11'8"  
300 GAL.  
1,025 GAL.  
11,980 LBS.  
(2) 7,000 LB.

**ADA MODELS**

**NO. OF STATIONS**  
**LENGTH/W TONGUE**  
**WIDTH/W STEPS**  
**HEIGHT/W AC**  
**FRESH TANK**  
**WASTE TANK**  
**WEIGHT**  
**AXLE TORSION**

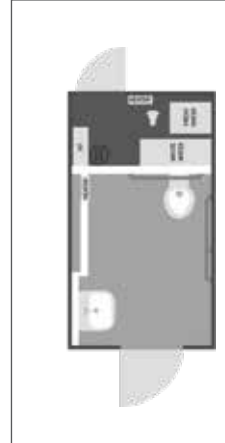

**11 FOOT**  
 1  
 11' | 16'  
 6' | 10 1/4"  
 10 1/4"  
 63 GAL.  
 123 GAL.  
 3,200 LBS.  
 5,200 LB.

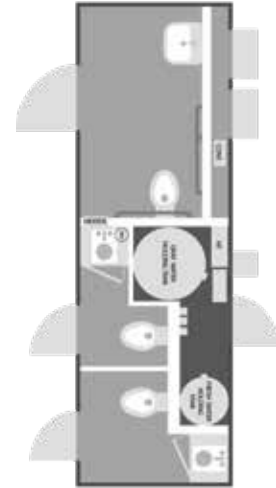

**19 FOOT**  
 3  
 19' | 24'  
 6' | 19'  
 10'10"  
 105 GAL.  
 300 GAL.  
 8,200 LBS.  
 10,000 LB.

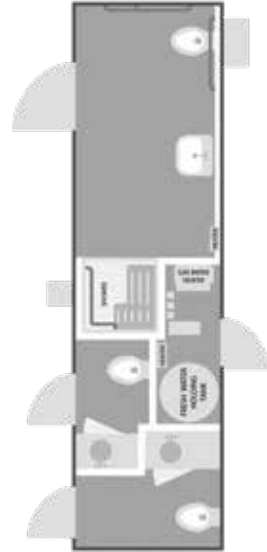

**23 FOOT**  
 3  
 23' | 28'  
 6' | 19'  
 10'10"  
 105 GAL.  
 300 GAL.  
 8,200 LBS.  
 (2) 10,000 LB.

**SHOWER MODELS**

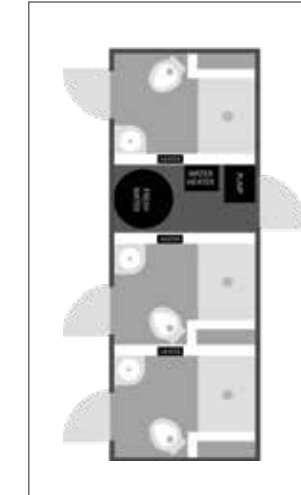

**18 FOOT | COMBO**  
 3  
 18' | 23'  
 6' | 7 1/6"  
 11'6"  
 200 GAL.  
 650 GAL.  
 6,000 LBS.  
 7,000 LB.

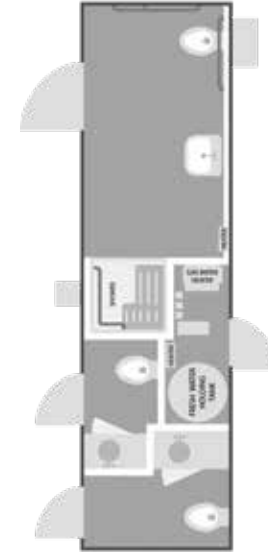

**23 FOOT | ADA**  
 3  
 23' | 28'  
 6' | 19'  
 10'10"  
 105 GAL.  
 300 GAL.  
 8,200 LBS.  
 (2) 10,000 LB.

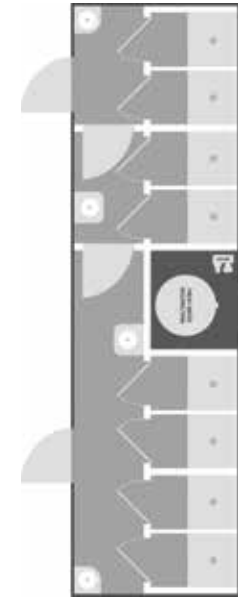

**28 FOOT | FLEX**  
 8  
 28' | 33'  
 8' | 10 1/6"  
 11'6"  
 200 GAL.  
 1,000 GAL.  
 11,450 LBS.  
 (2) 7,000 LB.

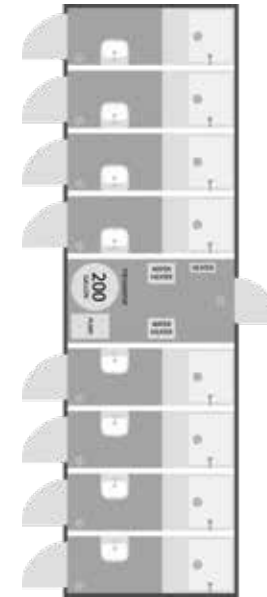

**28 FOOT | 8 DOOR**  
 8  
 28' | 32'  
 8'6" | 10'6"  
 11'6"  
 200 GAL.  
 1,000 GAL.  
 13,000 LBS.  
 (2) 7,000 LB.

**HANDWASH MODELS**

**NO. OF STATIONS**  
**LENGTH/W TONGUE**  
**WIDTH/W STEPS**  
**HEIGHT/W AC**  
**FRESH TANK**  
**WASTE TANK**  
**WEIGHT**  
**AXLE TORSION**

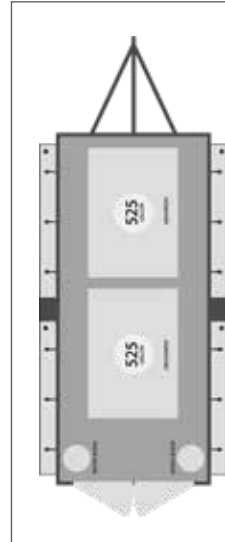

**SINK SUITE**  
 12  
 16' | 21'  
 6'  
 10'  
 525 GAL.  
 525 GAL.  
 4,000 LBS.  
 (2) 5,200 LB.

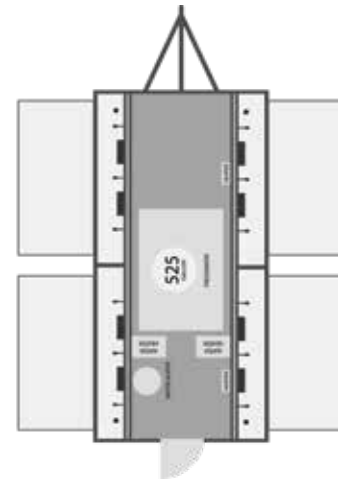

**PLUS**  
 12  
 16' | 21'  
 6'  
 10'  
 525 GAL.  
 525 GAL.  
 4,000 LBS.  
 (2) 5,200 LB.

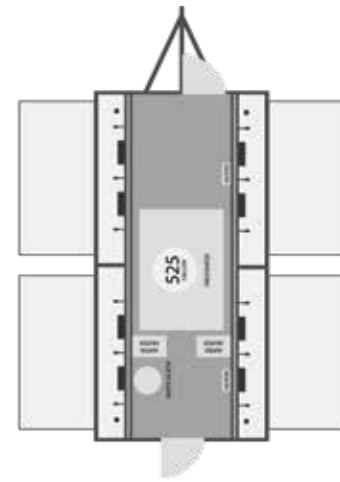

**DELUXE**  
 12  
 16' | 21'  
 6'  
 10'  
 525 GAL.  
 525 GAL.  
 4,000 LBS.  
 (2) 5,200 LB.

**SPECIALTY MODELS**

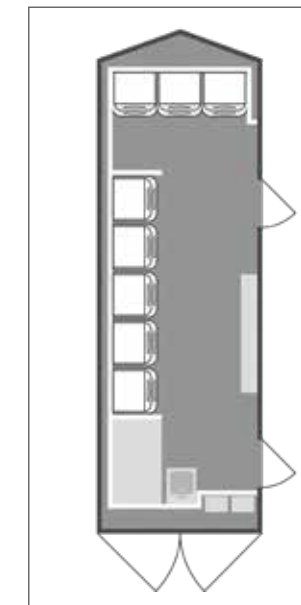

**24 FOOT | LAUNDRY**  
 8  
 24' | 31'  
 8' | 10'6"  
 11'8"  
 CONNECTION  
 CONNECTION  
 3,200 LBS.  
 (2) 7,000 LB.

**NEW MODELS COMING SOON**

